

# FBC SERIES

## 2mm PITCH CONNECTOR FOR DISCRETE CABLE/ CRIMP TYPE

RoHS  
Compliant

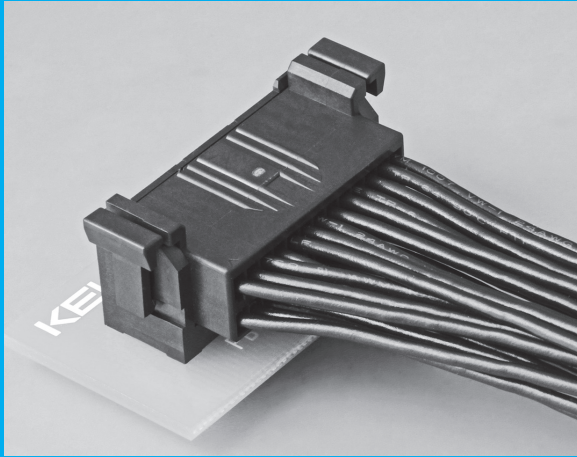

### FEATURES

- ▶ Side cable-entry type connector with stacked mating structure.
- ▶ Provided with an E-Lock type locking mechanism with high operability.
- ▶ The E-Lock mechanism prevents accidental disengagement, maintaining stable contact performance.
- ▶ With a twin-leaf pinching 2 point contact structure adopted as a contact mechanism, improved reliability based on stable contact performance is ensured.
- ▶ Three sizes : 26, 36 and 40 pins.
- ▶ For discrete cable. (#22 AWG, #24 AWG and #26 AWG)

### ORDER CODE

**FBC02**-□□□-**1**

①                      ②                      ③

\*Please order in multiples of the quantity per package.

- ① **[Type]** **FBC02** : Plug (Cable side connector)                      ③ **[Housing color]** **1** : Black
- ② **[Number of contacts]** **026** : 26 pin **036** : 36 pin **040** : 40 pin

\*Above order code FBC02-□□□-1 is for the housing only, contact terminals are sold separately. About #587 order code, Please refer to the bottom of this page.

### ORDER CODE

**FBC11**-□□□-**1-B**

①                      ②                      ③                      ④

\*Please order in multiples of the quantity per package.

- ① **[Type]** **FBC11** : Receptacle (PCB side connector)                      ③ **[Insulator color]** **1** : Black
- ② **[Number of contacts]** **026** : 26 pin **036** : 36 pin **040** : 40 pin                      ④ **[Height]** **B** : 3.5mm

### SPECIFICATIONS

Material and plating		Electrical characteristics	
Insulator material	Glass-filled Nylon 66 (UL94V-0)	Rated current	3A per contact
Contact material	[FBC02] Copper alloy	Contact resistance	40mΩ max.
	[FBC11] Brass	Dielectric withstanding voltage	650V AC for 1 minute
Contact plating	[FBC02] (Contact area)Gold over Nickel	Insulation resistance	1000MΩ min. at 500V DC
	(Crimping area)Tin over Nickel	Operating temperature	-40°C to +85°C
	[FBC11] Gold over Nickel	Applicable cable	#22/24/26 AWG Discrete wire cables (Insulation Dia.: φ1.0~φ1.5mm)

### Crimp contact

Unit : mm (inch)

#### ◆ Crimp contact for FBC02-□□□-1 plug (Cable side connector)

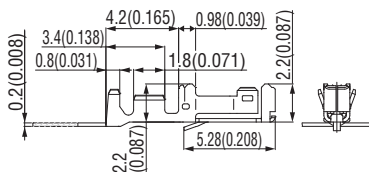

#### ▶ Product table

Packaging style	
Part number	Number of packaging
#587	10,000

### ORDER CODE

**#587**

①

\*Please order in multiples of the quantity per package.

- ① **[Contact]** **#587** : Crimping type contact for FBC02

### Assembly tool

Unit : mm (inch)

#### ▶ Crimping machine

Crimp contact	#587	Crimping machine	LPC220S
Manufacturer	Japan Automatic Machine Co., Ltd.	Applicator	EFS841800

\*A crimping machine and applicator are available for purchase from Japan Automatic Machine Co., Ltd.

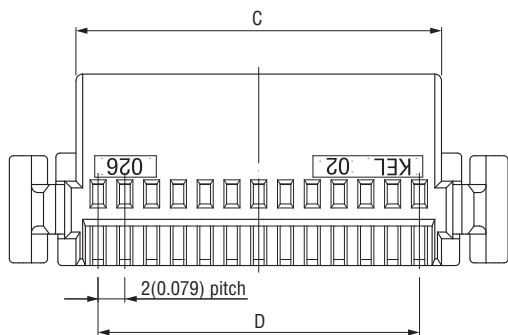
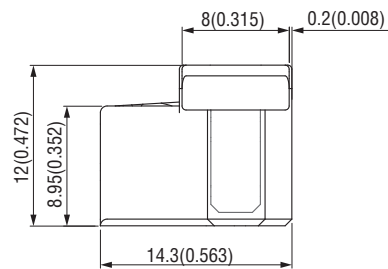
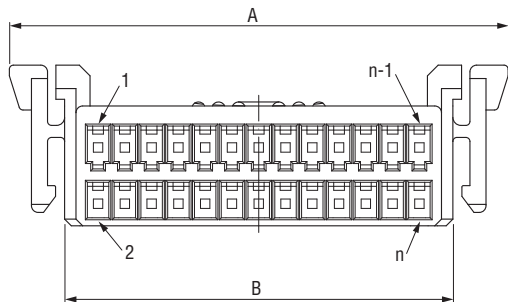
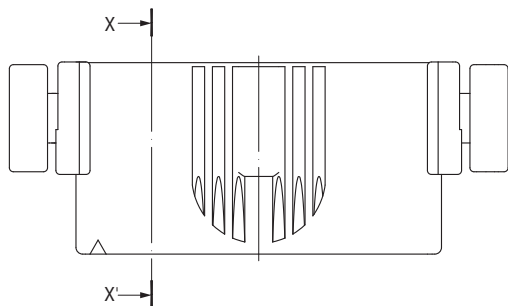
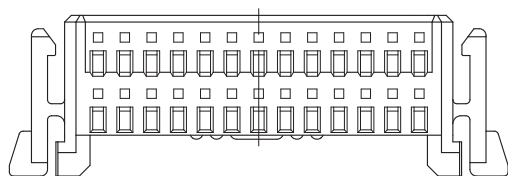
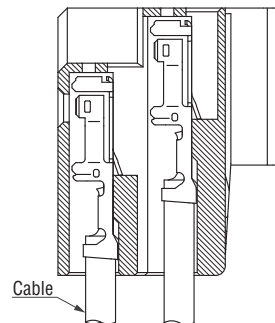
**X-X' Cross Section (With the contact inserted)**

"n" is number of contacts.

Packaging style

Tray

**Product table / Dimensions**

No. of contacts	Part number	A	B	C	D	Number of packaging
26	FBC02-026-1	37.25 (1.467)	29.0 (1.142)	27.3 (1.075)	24.0 (0.945)	125
36	FBC02-036-1	47.25 (1.860)	39.0 (1.535)	37.3 (1.469)	34.0 (1.339)	100
40	FBC02-040-1	51.25 (2.018)	43.0 (1.693)	41.3 (1.626)	38.0 (1.496)	100

# FBC11-□□□-1-B (Receptacle, PCB side connector)

Unit : mm(inch)

## ▶ Printed Circuit Board Layout (Component Side View)

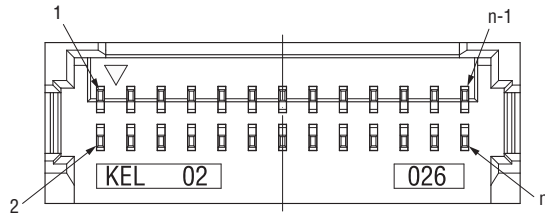
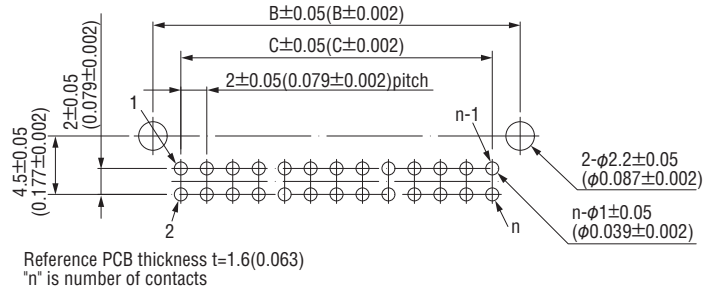

## X-X' Cross Section

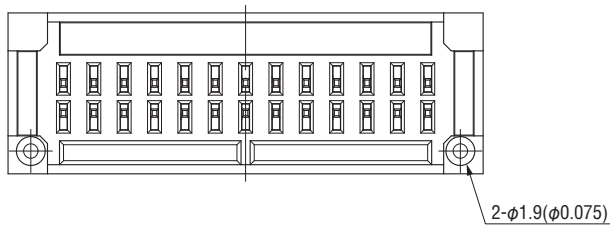
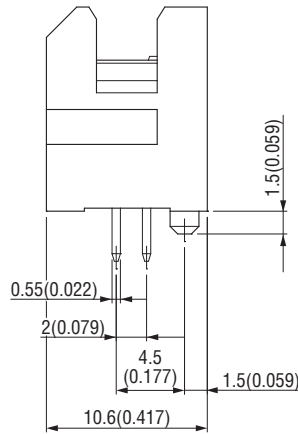
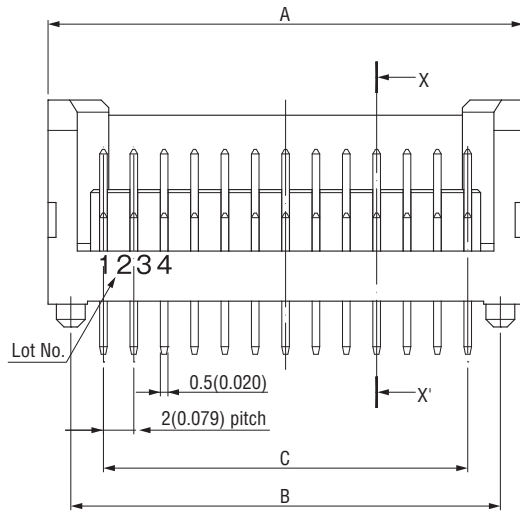
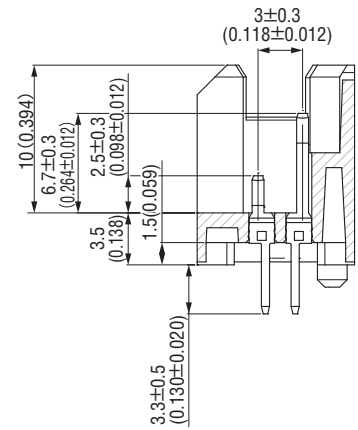

Packaging style

Pipe

## ▶ Product table / Dimensions

No. of contacts	Part number	A	B	C	Number of packaging
26	FBC11-026-1-B	31.3 (1.232)	28.3 (1.114)	24.0 (0.945)	16
36	FBC11-036-1-B	41.3 (1.626)	38.3 (1.508)	34.0 (1.339)	12
40	FBC11-040-1-B	45.3 (1.783)	42.3 (1.665)	38.0 (1.496)	11